

**Mill Creek Sunoco**

Portion of the Trenton West, PA/NJ 7.5-minute USGS Quadrangle from The National Map USGS Topo Map Server (2024).

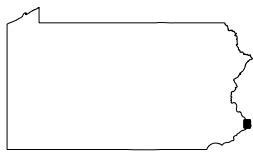

Scale (feet)  
0 500 1,000 2,000



Trenton West  
Quadrangle Location

**Mill Creek Sunoco | PAUSTIF Claim No. 23-0041(I)**

7040 Mill Creek Road, Levittown, Pennsylvania 19057

**Site Location Map**

<b>DRAWN:</b> JPB	<b>CHECKED:</b> CDO	<b>APPROVED:</b> JNK	<b>DATE:</b> 10/7/2024	<b>FIGURE:</b>
----------------------	------------------------	-------------------------	---------------------------	----------------

**GROUNDWATER SCIENCES CORPORATION**  
www.groundwatersciences.com

**1**





**MILL CREEK SUNOCO  
PROPERTY  
PARCEL ID 05-042-056**

FORMER CITGO STATION  
PROPERTY  
PARCEL ID 05-042-052

ALDI FOODS  
PROPERTY  
PARCEL ID 05-042-116-001

APARTMENT BUILDING  
PROPERTY  
PARCEL ID 05-042-055-001

**LEGEND**

- Site Boundary
- Parcel Boundary
- Stream or Creek (with Flow Direction)
- Topographic Contour (10' Interval)
- Topographic Contour (2' Interval)

SOURCES:  
Bucks County Parcel & Floodplain Viewer, last accessed May 2024; parcel data from March 2024.  
GeoTrek Environmental and Surveying, LLC (Doylestown, PA; "Survey Plan", dated 4/12/2024).  
PASDA topographic contours dated 2006-2008.  
PEMA aerial photo dated 2018.  
USGS National Water Dashboard (stream flow direction), last accessed May 2024.

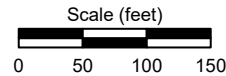

**Mill Creek Sunoco | PAUSTIF Claim No. 23-0041(I)**  
7040 Mill Creek Road, Levittown, Pennsylvania 19057

**Site Area Map**

<b>DRAWN:</b> JPB	<b>CHECKED:</b> CDO	<b>APPROVED:</b> JNK	<b>DATE:</b> 10/7/2024	<b>FIGURE:</b>
----------------------	------------------------	-------------------------	---------------------------	----------------

**GROUNDWATER SCIENCES CORPORATION**  
www.groundwatersciences.com

**2**



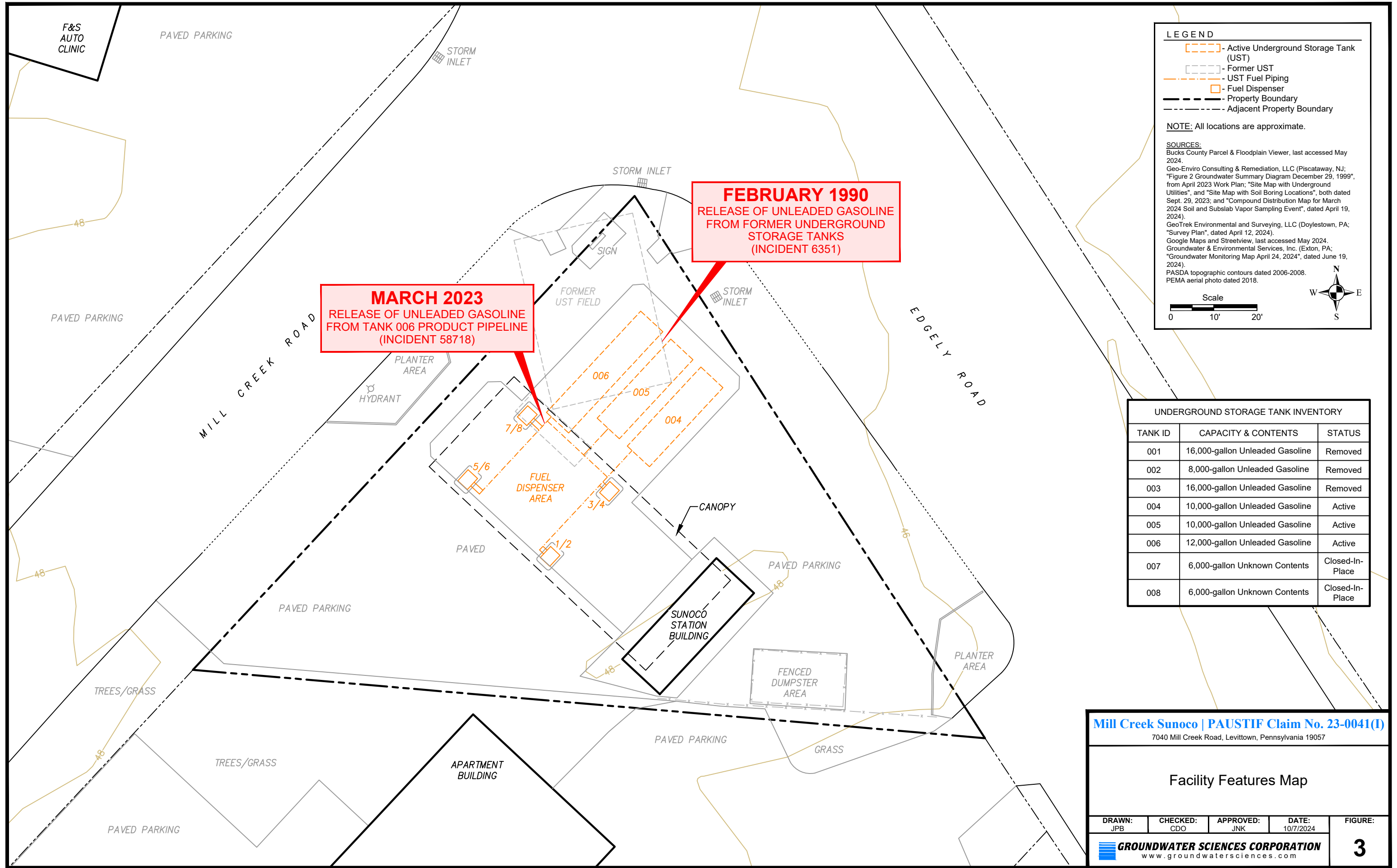

**Mill Creek Sunoco | PAUSTIF Claim No. 23-0041(I)**  
7040 Mill Creek Road, Levittown, Pennsylvania 19057

**Facility Features Map**

<b>DRAWN:</b> JPB	<b>CHECKED:</b> CDO	<b>APPROVED:</b> JNK	<b>DATE:</b> 10/7/2024	<b>FIGURE:</b> <b>3</b>
<b>GROUNDWATER SCIENCES CORPORATION</b> www.groundwatersciences.com				

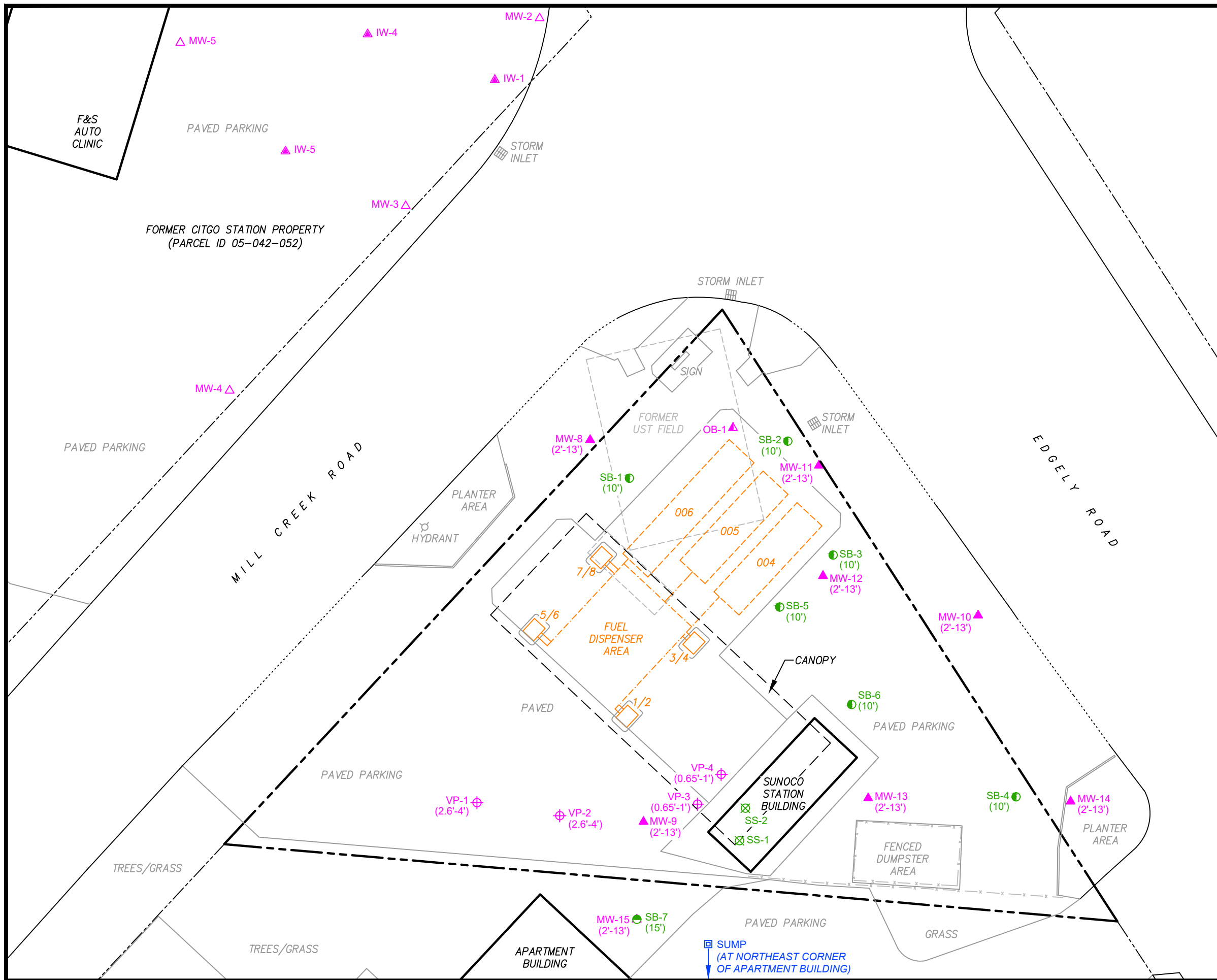

**LEGEND**

- ▲ - Monitoring Well (July 2023 and March 2024)
- ▲ - Observation Well
- ▲ - Monitoring Well at Former Citgo Property
- ▲ - Injection Well at Former Citgo Property
- - Sump
- - Soil Boring (May 2023)
- - Soil Boring (March 2024)
- ⊕ - Vapor Point (May 2023)
- ⊗ - Sub-Slab Soil Vapor Point (March 2024)
- (10') - Total Drilled Depth (Feet Below Ground Surface)
- (2'-13') - Open Interval (Feet Below Ground Surface)
- ▭ - Active Underground Storage Tank (UST)
- ▭ - Former UST
- - - UST Fuel Piping
- ▭ - Fuel Dispenser
- - - Property Boundary
- - - Adjacent Property Boundary
- 48— - Topographic Contour (2' Interval)

**NOTE:** All locations are approximate.

**SOURCES:**  
 Bucks County Parcel & Floodplain Viewer, last accessed May 2024.  
 Geo-Enviro Consulting & Remediation, LLC (Piscataway, NJ; "Figure 2 Groundwater Summary Diagram December 29, 1999", from April 2023 Work Plan; "Site Map with Underground Utilities", and "Site Map with Soil Boring Locations", both dated Sept. 29, 2023, and "Compound Distribution Map for March 2024 Soil and Subslab Vapor Sampling Event", dated April 19, 2024).  
 GeoTrek Environmental and Surveying, LLC (Doylestown, PA; "Survey Plan", dated April 12, 2024).  
 Google Maps and Streetview, last accessed May 2024.  
 Groundwater & Environmental Services, Inc. (Exton, PA; "Groundwater Monitoring Map April 24, 2024", dated June 19, 2024).  
 PASDA topographic contours dated 2006-2008.  
 PEMA aerial photo dated 2018.

Scale: 0 10' 20'

**Mill Creek Sunoco | PAUSTIF Claim No. 23-0041(I)**  
 7040 Mill Creek Road, Levittown, Pennsylvania 19057

**Sample Location Map**

<b>DRAWN:</b> JPB	<b>CHECKED:</b> CDO	<b>APPROVED:</b> JNK	<b>DATE:</b> 10/7/2024	<b>FIGURE:</b> 4
----------------------	------------------------	-------------------------	---------------------------	---------------------

**GROUNDWATER SCIENCES CORPORATION**  
 www.groundwatersciences.com

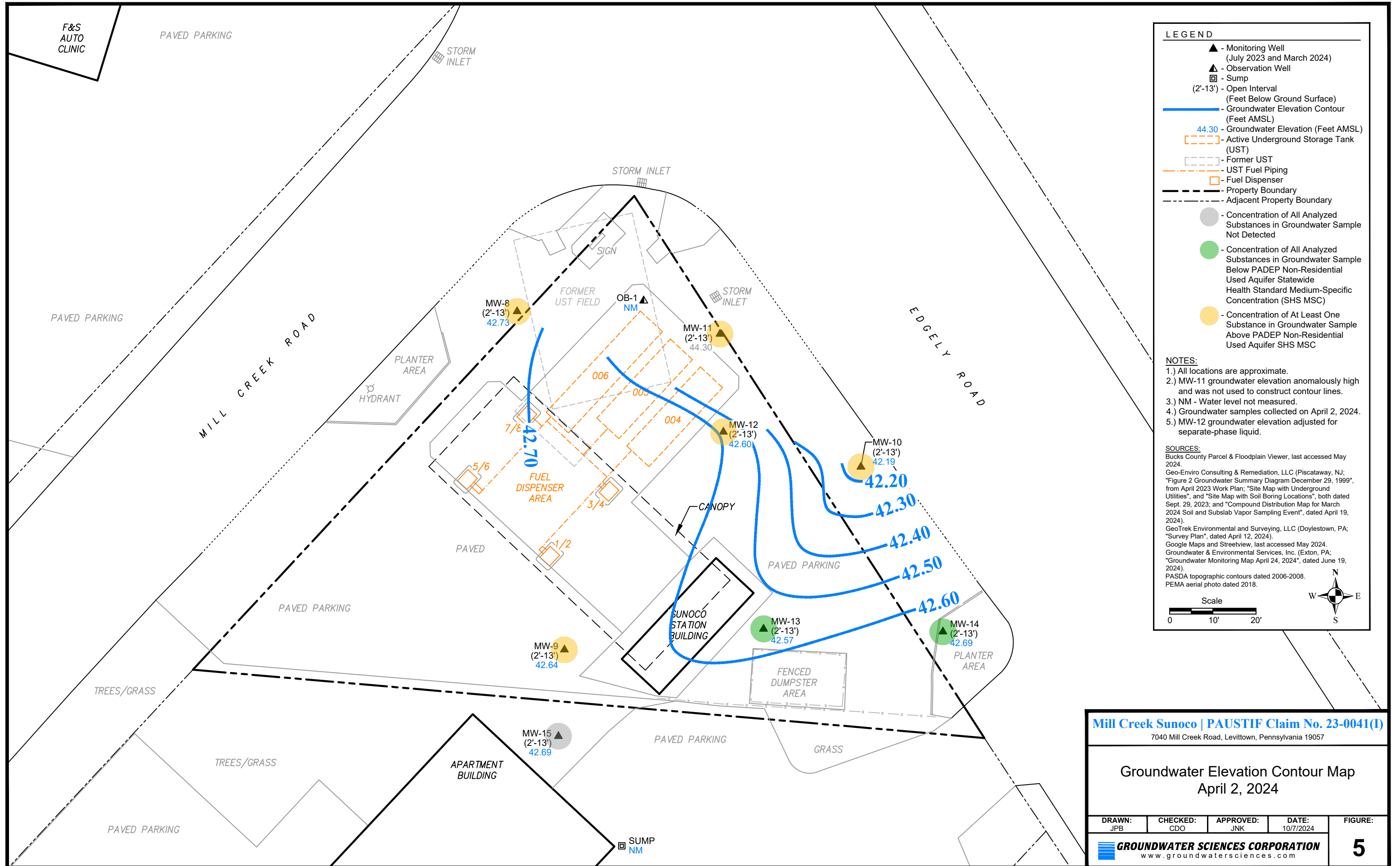

**Mill Creek Sunoco | PAUSTIF Claim No. 23-0041(I)**  
 7040 Mill Creek Road, Levittown, Pennsylvania 19057

**Groundwater Elevation Contour Map**  
 April 2, 2024

<b>DRAWN:</b> JPB	<b>CHECKED:</b> CDO	<b>APPROVED:</b> JNK	<b>DATE:</b> 10/7/2024	<b>FIGURE:</b> 5
<b>GROUNDWATER SCIENCES CORPORATION</b> www.groundwatersciences.com				

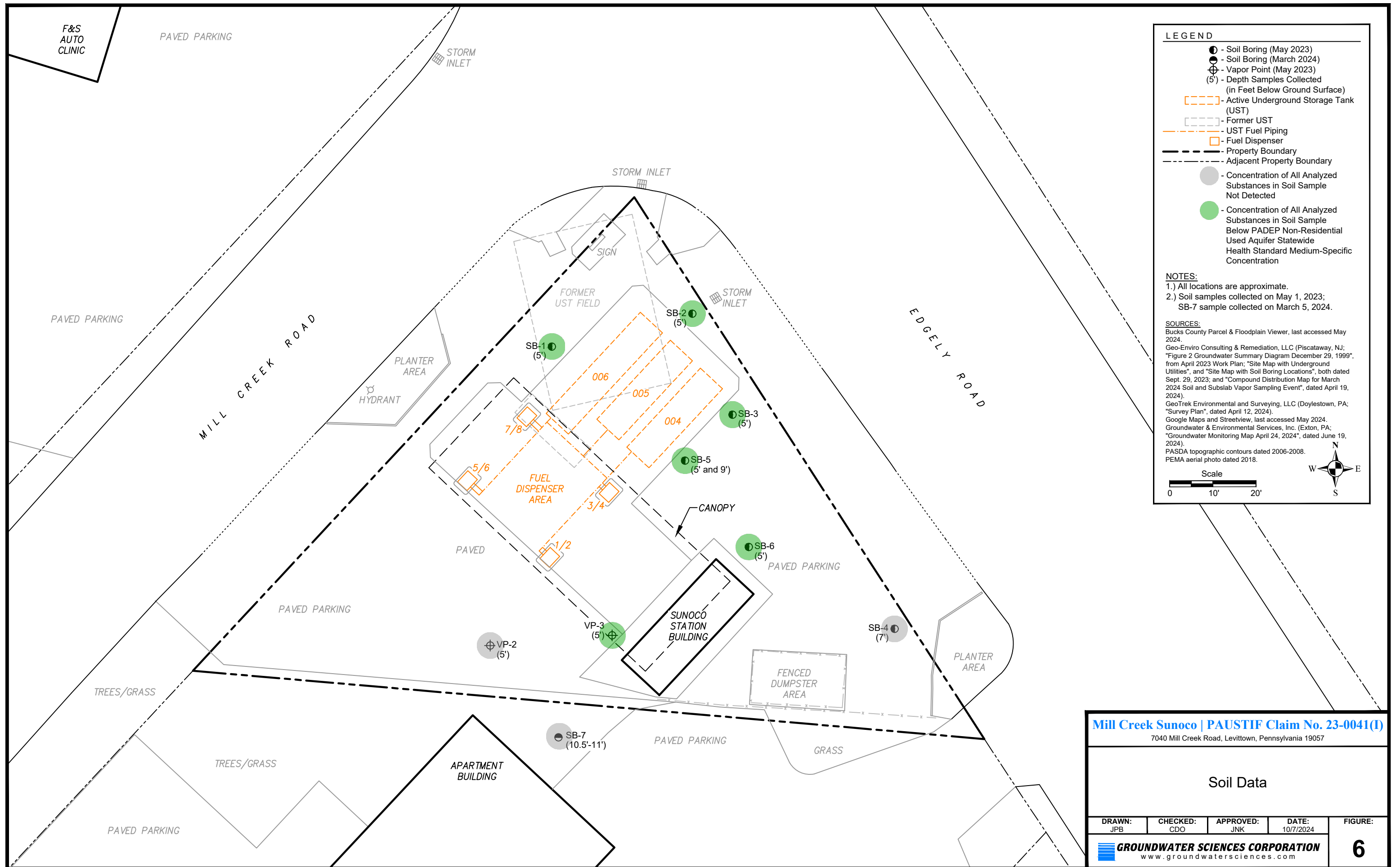

**Mill Creek Sunoco | PAUSTIF Claim No. 23-0041(I)**  
 7040 Mill Creek Road, Levittown, Pennsylvania 19057

**Soil Data**

<b>DRAWN:</b> JPB	<b>CHECKED:</b> CDO	<b>APPROVED:</b> JNK	<b>DATE:</b> 10/7/2024	<b>FIGURE:</b> <b>6</b>
<b>GROUNDWATER SCIENCES CORPORATION</b> www.groundwatersciences.com				



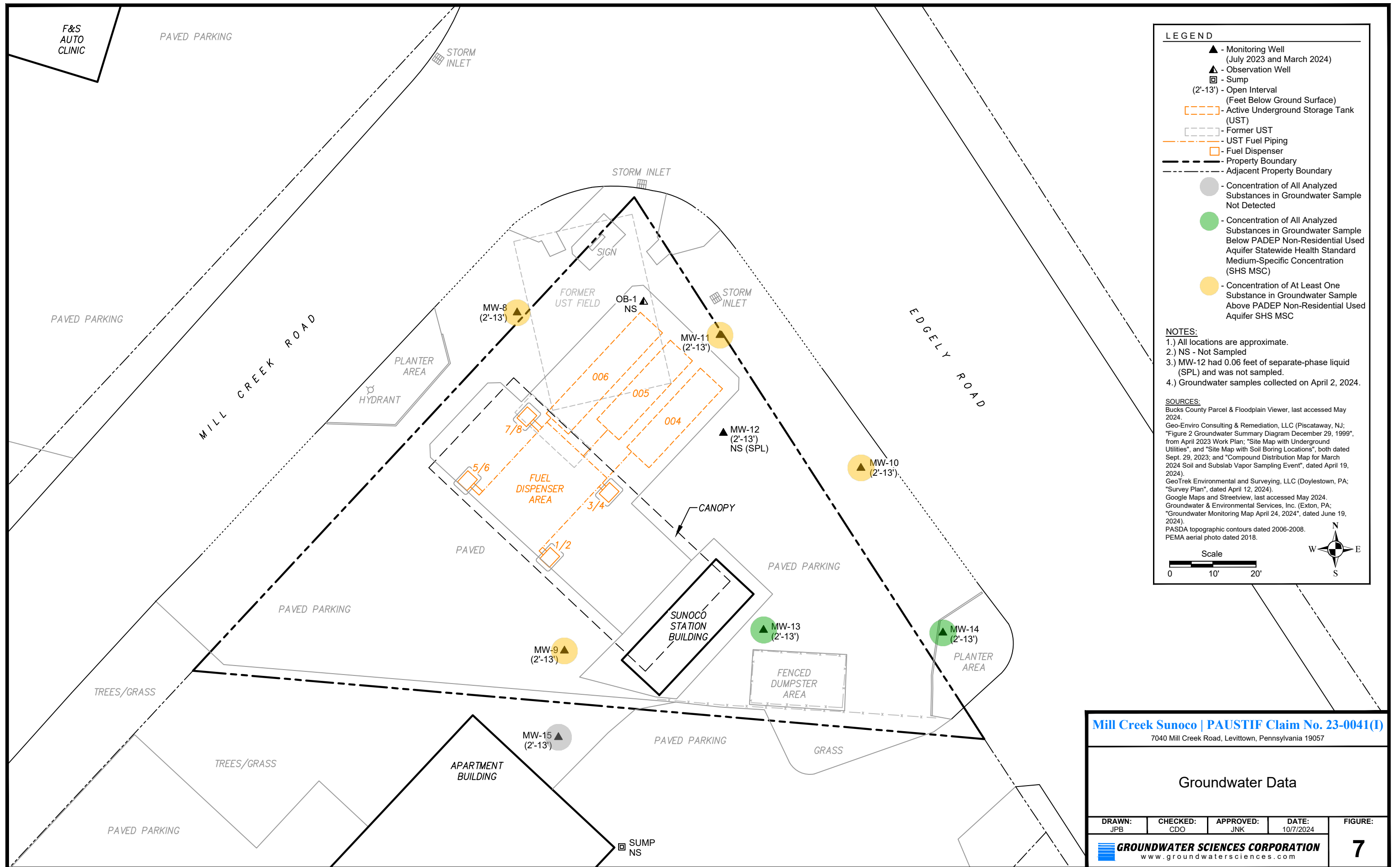

**Mill Creek Sunoco | PAUSTIF Claim No. 23-0041(I)**  
 7040 Mill Creek Road, Levittown, Pennsylvania 19057

**Groundwater Data**

<b>DRAWN:</b> JPB	<b>CHECKED:</b> CDO	<b>APPROVED:</b> JNK	<b>DATE:</b> 10/7/2024	<b>FIGURE:</b> 7
<b>GROUNDWATER SCIENCES CORPORATION</b> www.groundwatersciences.com				

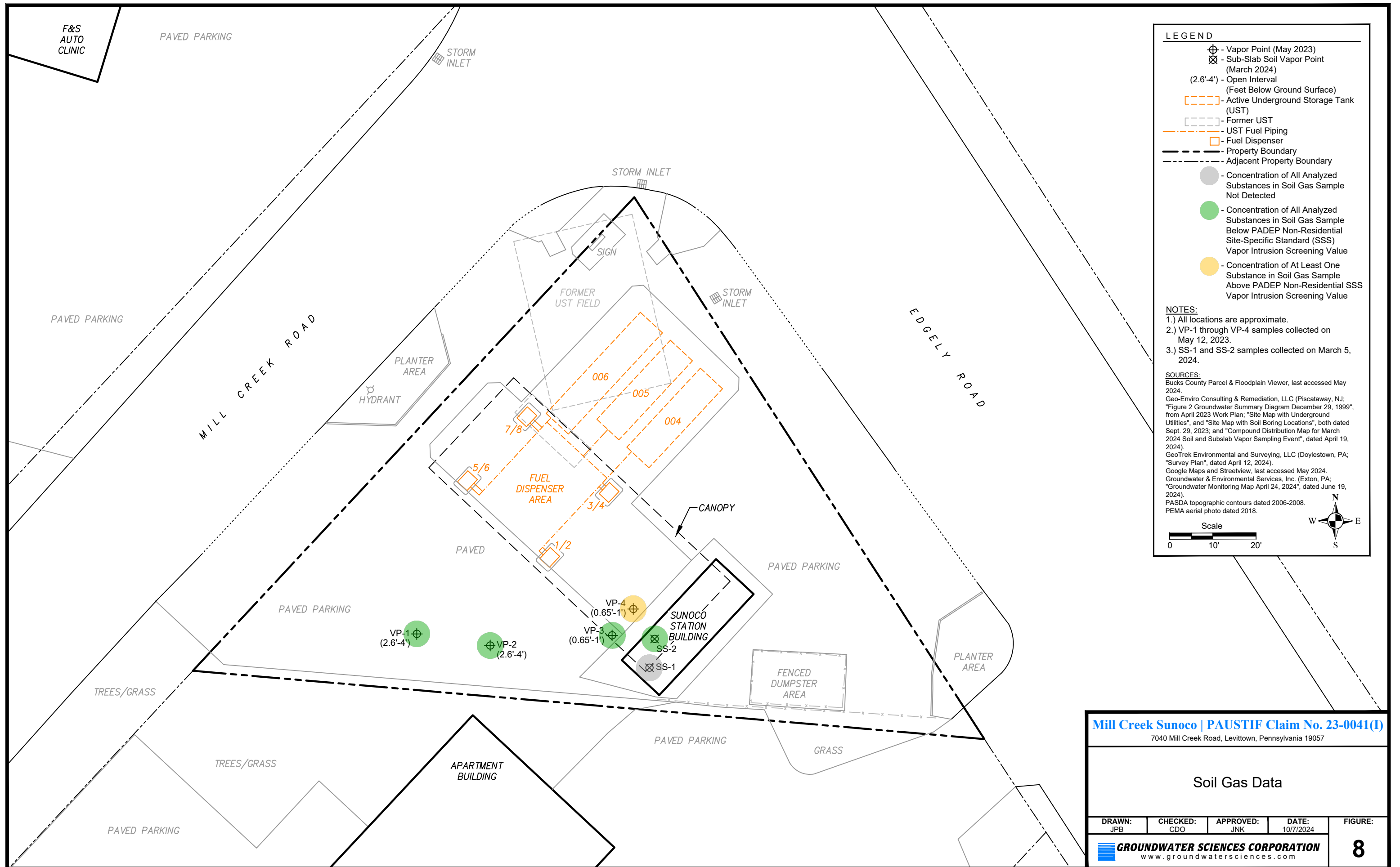

**LEGEND**

- ⊕ - Vapor Point (May 2023)
- ⊗ - Sub-Slab Soil Vapor Point (March 2024)
- (2.6'-4') - Open Interval (Feet Below Ground Surface)
- Active Underground Storage Tank (UST)
- Former UST
- UST Fuel Piping
- Fuel Dispenser
- Property Boundary
- Adjacent Property Boundary
- - Concentration of All Analyzed Substances in Soil Gas Sample Not Detected
- - Concentration of All Analyzed Substances in Soil Gas Sample Below PADEP Non-Residential Site-Specific Standard (SSS) Vapor Intrusion Screening Value
- - Concentration of At Least One Substance in Soil Gas Sample Above PADEP Non-Residential SSS Vapor Intrusion Screening Value

**NOTES:**

- 1.) All locations are approximate.
- 2.) VP-1 through VP-4 samples collected on May 12, 2023.
- 3.) SS-1 and SS-2 samples collected on March 5, 2024.

**SOURCES:**  
 Bucks County Parcel & Floodplain Viewer, last accessed May 2024.  
 Geo-Enviro Consulting & Remediation, LLC (Piscataway, NJ): "Figure 2 Groundwater Summary Diagram December 29, 1999", from April 2023 Work Plan; "Site Map with Underground Utilities", and "Site Map with Soil Boring Locations", both dated Sept. 29, 2023; and "Compound Distribution Map for March 2024 Soil and Subslab Vapor Sampling Event", dated April 19, 2024).  
 GeoTrek Environmental and Surveying, LLC (Doylestown, PA): "Survey Plan", dated April 12, 2024).  
 Google Maps and Streetview, last accessed May 2024.  
 Groundwater & Environmental Services, Inc. (Exton, PA): "Groundwater Monitoring Map April 24, 2024", dated June 19, 2024).  
 PASDA topographic contours dated 2006-2008.  
 PEMA aerial photo dated 2018.

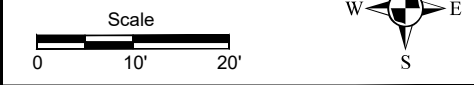

**Mill Creek Sunoco | PAUSTIF Claim No. 23-0041(I)**  
 7040 Mill Creek Road, Levittown, Pennsylvania 19057

**Soil Gas Data**

<b>DRAWN:</b> JPB	<b>CHECKED:</b> CDO	<b>APPROVED:</b> JNK	<b>DATE:</b> 10/7/2024	<b>FIGURE:</b> 8
----------------------	------------------------	-------------------------	---------------------------	---------------------

**GROUNDWATER SCIENCES CORPORATION**  
 www.groundwatersciences.com



