

FENCE POST

TANK  
FIELD

VENT

PUMP  
CANOPY

FILBERT STREET 60' SR 0453



MW-7

FIGURE XX SOIL SAMPLE LOCATION MAP JANUARY 22, 2018			
SITE CHARACTERIZATION REPORT CHOUTA HOLDINGS, LLC - FUEL-OIL CURWENSVILLE FACILITY ID# 17-51221 CURWENSVILLE BOROUGH CLEARFIELD COUNTY, PENNSYLVANIA			
DATE: 1-25-2018	APPROX. SCALE: SEE SCALE BAR	DRAWN BY: RMB	

#### LEGEND

- MW-5 MONITORING WELL LOCATION
- MW-1 MONITORING WELL/SOIL SAMPLE LOCATION
- SB-1 2014 SOIL SAMPLE LOCATION (GROPOBE)
- Natural Gas Line
- Municipal Water Line
- Sanitary / Stormwater Line
- SB-14 SOIL SAMPLE LOCATION (GROPOBE) January 22, 2018

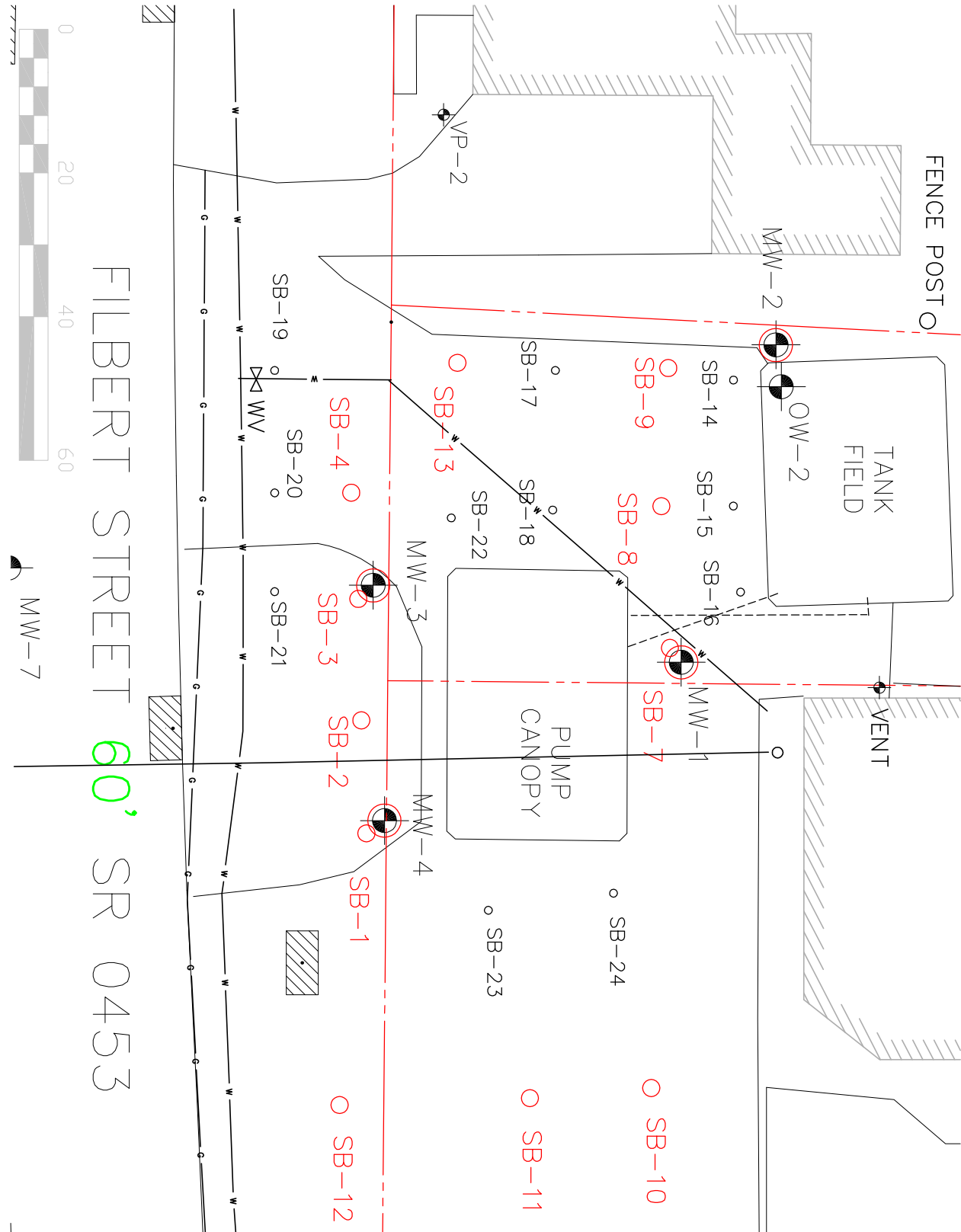

*Curwenville, Inc.*  
 P.O. BOX 44  
 DELMONT, PA 15626  
 PROJECT NUMBER:  
 SURVEY FIELD WORK PREPARED BY MORRIS  
 KNOWLES AND ASSOCIATES INC.

CLIENT: Chiquita Holdings  
 PROJECT: Fuel-On Service Station  
 DRILLING COMPANY: Cribbs & Associates  
 LOGGED BY: J. Thorn

PROJECT # \_\_\_\_\_ DATE DRILLED: 1/22/2018  
 LOCATION: Curwensville, PA  
 RIG: Geo-Probe BOREHOLE: 2.5"  
 DRILLING METHOD: Macro-Sampler GW Level: N/A @ 0 hrs.

DEPTH (FT.)	SAMPLE ID	BLOWCOUNTS	RECOVERY (FEET)	DESCRIPTION	HEADSPACE	USCS	DEPTH (FT.)
1	S-1	N/A	4.0	(0.0'-0.5') Black <b>asphalt</b> and limestone gravel.	73		1
2	S-2	N/A	4.0	(0.5'-1.0') Dark gray <b>Silt</b> and gravel, (gravel is dark gray limestone), dry. (Fill)	1.4		2
3	S-3	N/A	4.0	(1.0'-3.8') Black <b>Silt</b> , traces of clay, fine sand and gravel, (gravel is gray sandstone fragments), low plasticity, dry to damp. Sample SB-24 1.0'-2.0' collected at 15:20. (Fill)	0.0		3
4	S-4	N/A	3.7	(3.8'-4.0') Red orange <b>Silty Sand</b> , damp. (Fill)	0.5		4
5	S-5	N/A	3.7	(4.0'-6.0') Black <b>Silty Sand</b> , damp. (Alluvial)	0.0		5
6				(6.0'-8.0') Gray and Brown <b>Silty Sand</b> , damp. Sample SB-24 6.0'-8.0' collected at 15:25. Transitions to gray. (Alluvial)			6
7							7
8							8
9							9
10							10
11							11
12							12
13							13
14							14
15							15
16							16
17							17
18							18
19							19
20							20

**Bottom of Boring @ 8.0'**

CLIENT: Chiquita Holdings  
 PROJECT: Fuel-On Service Station  
 DRILLING COMPANY: Cribbs & Associates  
 LOGGED BY: J. Thorn

PROJECT # \_\_\_\_\_ DATE DRILLED: 1/22/2018  
 LOCATION: Curwensville, PA  
 RIG: Geo-Probe BOREHOLE: 2.5"  
 DRILLING METHOD: Macro-Sampler GW Level: N/A @ 0 hrs.

DEPTH (FT.)	SAMPLE ID	BLOWCOUNTS	RECOVERY (FEET)	DESCRIPTION	HEADSPACE	USCS	DEPTH (FT.)
1	S-1	N/A	3.0	(0.0'-0.5') Black <b>asphalt</b> and limestone gravel.	117.7		1
2	S-2	N/A	3.0	(0.5'-4.5') Black, gray and brown <b>Silt</b> and sand, some gravel (limestone and fine-grained gray and yellow brown sandstone fragments), red and yellow brick fragments, non-plastic, damp. (Fill)	136.6		2
3	S-3	N/A	3.0	Sample SB-23 3.0'-4.0' collected at 14:50.	273.1		3
4	S-4	N/A	0.1	(4.5'-7.0') Gray <b>Silty Sand</b> and gravel, (gravel is light gray, fine-grained sandstone fragments), damp to moist, becomes wet @ 5.0'. Sample SB-23 5.0'-6.0' collected at 14:55.	54.7		4
5	S-5	N/A	0.1	(Alluvial)	14.9		5
6				<b>Refusal @ 7.0'</b>			6
7							7
8							8
9							9
10							10
11							11
12							12
13							13
14							14
15							15
16							16
17							17
18							18
19							19
20							20

CLIENT: Chiquita Holdings  
 PROJECT: Fuel-On Service Station  
 DRILLING COMPANY: Cribbs & Associates  
 LOGGED BY: J. Thorn

PROJECT # \_\_\_\_\_ DATE DRILLED: 1/22/2018  
 LOCATION: Curwensville, PA  
 RIG: Geo-Probe BOREHOLE: 2.5"  
 DRILLING METHOD: Macro-Sampler GW Level: N/A @ 0 hrs.

DEPTH (FT.)	SAMPLE ID	BLOWCOUNTS	RECOVERY (FEET)	DESCRIPTION	HEADSPACE	USCS	DEPTH (FT.)
1	S-1	N/A	4.0	(0.0'-0.5') Black <b>asphalt</b> and limestone gravel.	11.9		1
2	S-2	N/A	4.0	(0.5'-1.5') Gray and brown <b>Silt</b> and gravel, damp. (Fill)	61.5		2
3	S-3	N/A	4.0	(1.5'-3.7') Olive gray <b>Silt</b> , trace clay some sand and gravel, (gravel is highly weathered shale and fine-grained sandstone fragments), damp. (Fill)	3089		3
4	S-4	N/A	0.1	<i>Sample SB-22 3.0' collected at 14:10.</i> (3.7'-4.1') Black <b>Silt</b> , trace clay some sand and gravel, (gravel is highly weathered shale and fine-grained sandstone fragments), wet. (Fill)	1731		4
5				<i>Sample SB-22 4.0' collected at 14:15.</i> <b>Refusal @ 4.1'</b>			5
6							6
7							7
8							8
9							9
10							10
11							11
12							12
13							13
14							14
15							15
16							16
17							17
18							18
19							19
20							20

CLIENT: Chiquita Holdings  
 PROJECT: Fuel-On Service Station  
 DRILLING COMPANY: Cribbs & Associates  
 LOGGED BY: J. Thorn

PROJECT # \_\_\_\_\_ DATE DRILLED: 1/22/2018  
 LOCATION: Curwensville, PA  
 RIG: Geo-Probe BOREHOLE: 2.5"  
 DRILLING METHOD: Macro-Sampler GW Level: N/A @ 0 hrs.

DEPTH (FT.)	SAMPLE ID	BLOWCOUNTS	RECOVERY (FEET)	DESCRIPTION	HEADSPACE	USCS	DEPTH (FT.)
1	S-1	N/A	2.0	(0.0'-0.5') Brown <b>Silt</b> , topsoil, trace roots and gravel, trace clay, low plasticity, damp.	0.1		1
2				(0.5'-4.0') Brown <b>Silt</b> , traces of clay, sand and gravel (gravel is highly weathered fine-grained sandstone fragments), low to moderate plasticity, moist. (Fill)			2
3	S-2			Sample SB-21 2.0'-4.0' collected at 13:50.	1.3		3
4				<b>Refusal @ 4.0'</b>			4
5							5
6							6
7							7
8							8
9							9
10							10
11							11
12							12
13							13
14							14
15							15
16							16
17							17
18							18
19							19
20							20

CLIENT: Chiquita Holdings  
 PROJECT: Fuel-On Service Station  
 DRILLING COMPANY: Cribbs & Associates  
 LOGGED BY: J. Thorn

PROJECT # \_\_\_\_\_ DATE DRILLED: 1/22/2018  
 LOCATION: Curwensville, PA  
 RIG: Geo-Probe BOREHOLE: 2.5"  
 DRILLING METHOD: Macro-Sampler GW Level: @ 0 hrs.

DEPTH (FT.)	SAMPLE ID	BLOWCOUNTS	RECOVERY (FEET)	DESCRIPTION	HEADSPACE	USCS	DEPTH (FT.)
1	S-1	N/A	4.0	(0.0'-0.5') Black <b>asphalt</b> and limestone gravel.	0.1		1
2	S-2			(0.5'-2.5') Grey and brown <b>Silt and gravel</b> , (gravel is light gray shale and gray sandstone fragments), non-plastic, dry. (Fill)	21.1		2
3	S-3			Sample SB-20 2.0'-3.0' collected at 13:15.	19.5		3
4				(2.5'-3.5') Dark grey <b>Silt</b> , some gravel, (gravel is highly weathered shale and fine-grained sandstone), trace clay, low plasticity, damp. (Fill)			4
5				(3.5'-4.0') Dark gray <b>Silt</b> , little sand and clay, moderate plasticity, moist to wet.			5
6				Sample SB-20 3.0'-4.0' collected at 13:20. <b>Refusal @ 4.0'</b>			6
7							7
8							8
9							9
10							10
11							11
12							12
13							13
14							14
15							15
16							16
17							17
18							18
19							19
20							20

CLIENT: Chiquita Holdings  
 PROJECT: Fuel-On Service Station  
 DRILLING COMPANY: Cribbs & Associates  
 LOGGED BY: J. Thorn

PROJECT # \_\_\_\_\_ DATE DRILLED: 1/22/2018  
 LOCATION: Curwensville, PA  
 RIG: Geo-Probe BOREHOLE: 2.5"  
 DRILLING METHOD: Macro-Sampler GW Level: N/A @ 0 hrs.

DEPTH (FT.)	SAMPLE ID	BLOWCOUNTS	RECOVERY (FEET)	DESCRIPTION	HEADSPACE	USCS	DEPTH (FT.)
1	S-1	N/A	4.0	(0.0'-0.3') Black <b>asphalt</b> and limestone gravel.	1		1
2				(0.3'-3.0') Dark grey and yellow brown <b>Silt and gravel</b> , trace clay, non-plastic, dry.			2
3	S-2			(Fill)	0.1		3
4	S-3			Sample SB-19 3.0'-4.0' collected at 12:30.	2.6		4
5				(3.0'-3.5') Dark grey and yellow brown <b>Silt and gravel</b> , little clay, low plasticity, dry.			5
6	S-4	N/A	3.2	(3.5'-4.2') Dark brown <b>Silt</b> , abundant wood fragments, trace gravel dry. (Fill)	0.4		6
7				(4.2'-5.0') Red brown <b>Silt</b> , trace clay, moderate plasticity, moist to wet.			7
8	S-5			Sample SB-19 4.0'-6.0' collected at 12:45. (Fill)	0.4		8
9				(5.0'-7.0') Grey <b>Sandy Silt</b> , trace clay with yellow brown sandstone fragments, low plasticity, moist to wet.			9
10				(Alluvial)			10
11				(7.0'-8.0') Yellow brown and grey <b>Sandy Silt</b> , low plasticity, moist to wet.			11
12				(Alluvial)			12
13							13
14							14
15							15
16							16
17							17
18							18
19							19
20							20

**Bottom of Boring @ 8.0'**

CLIENT: Chiquita Holdings  
 PROJECT: Fuel-On Service Station  
 DRILLING COMPANY: Cribbs & Associates  
 LOGGED BY: J. Thorn

PROJECT # \_\_\_\_\_ DATE DRILLED: 1/22/2018  
 LOCATION: Curwensville, PA  
 RIG: Geo-Probe BOREHOLE: 2.5"  
 DRILLING METHOD: Macro-Sampler GW Level: N/A @ 0 hrs.

DEPTH (FT.)	SAMPLE ID	BLOWCOUNTS	RECOVERY (FEET)	DESCRIPTION	HEADSPACE	USCS	DEPTH (FT.)
1	S-1	N/A	4.0	(0.0'-0.5') Black <b>asphalt</b> and limestone gravel.	2.9		1
2	S-2	N/A	4.0	(0.5'-5.0') Brown and dark grey <b>Silt and gravel</b> , little sand, non-plastic, dry. (Fill)	52.4		2
3	S-3	N/A	4.0	Sample SB-18 2.0'-3.0' collected at 12:00.	42.1		3
4	S-4	N/A	1.0	Becomes Dark gray.	86.0		4
5				Sample SB-18 4.0'-6.0' collected at 12:05.			5
6				(5.0'-6.0') Dark grey <b>Silt</b> , little clay, moist to wet. (Fill)			6
7				<b>Refusal @ 6.0'</b>			7
8							8
9							9
10							10
11							11
12							12
13							13
14							14
15							15
16							16
17							17
18							18
19							19
20							20



CLIENT: Chiquita Holdings  
 PROJECT: Fuel-On Service Station  
 DRILLING COMPANY: Cribbs & Associates  
 LOGGED BY: J. Thorn

PROJECT # \_\_\_\_\_ DATE DRILLED: 1/22/2018  
 LOCATION: Curwensville, PA  
 RIG: Geo-Probe BOREHOLE: 2.5"  
 DRILLING METHOD: Macro-Sampler GW Level: N/A @ 0 hrs.

DEPTH (FT.)	SAMPLE ID	BLOWCOUNTS	RECOVERY (FEET)	DESCRIPTION	HEADSPACE	USCS	DEPTH (FT.)
1	S-1	N/A	3.5	(0.0'-0.3') Black <b>asphalt</b> and limestone gravel.	0.6		1
2				(0.3'-2.0') Brown and grey <b>Silt and gravel</b> , dry. (Fill)			2
3	S-2			(2.0'-3.0') Grey <b>Silt</b> , little clay, trace gray shale fragments, moderate plasticity, damp. <i>Sample SB-17 2.0'-3.0' collected at 11:30.</i>	2.8		3
4	S-3			(3.0'-4.5') Yellow brown <b>Silty Clay</b> , little sand, trace clay, low plasticity, moist. (Fill)	0.1		4
5	S-4	N/A	1.5	(4.5'-5.0') Red orange <b>Silt</b> , little sand, trace clay, low plasticity, moist.	2.0		5
6				(5.0'-8.0') Medium brown <b>Sandy Silt</b> , trace clay, low plasticity, wet. (Alluvial)			6
7	S-5			<i>Sample SB-17 6.0'-8.0' collected at 11:35.</i>	8.7		7
8				<b>Bottom of Boring @ 8.0'</b>			8
9							9
10							10
11							11
12							12
13							13
14							14
15							15
16							16
17							17
18							18
19							19
20							20

CLIENT: Chiquita Holdings  
 PROJECT: Fuel-On Service Station  
 DRILLING COMPANY: Cribbs & Associates  
 LOGGED BY: J. Thorn

PROJECT # \_\_\_\_\_ DATE DRILLED: 1/22/2018  
 LOCATION: Curwensville, PA  
 RIG: Geo-Probe BOREHOLE: 2.5"  
 DRILLING METHOD: Macro-Sampler GW Level: N/A @ 0 hrs.

DEPTH (FT.)	SAMPLE ID	BLOWCOUNTS	RECOVERY (FEET)	DESCRIPTION	HEADSPACE	USCS	DEPTH (FT.)
—	S-1	N/A	3.5	(0.0'-0.3') Black <b>asphalt</b> and limestone gravel.	149.6		—
1				(0.3'-5.0') Brown and grey <b>Silt and gravel</b> , trace clay, little sand, dry to damp.			1
2				Sample SB-16 1.0'-2.0' collected at 11:00.			2
3	S-2	N/A	0.5	(Fill)	80.2		3
4	S-3				50.5		4
5	S-4			Becomes dark gray, wet.	33.4		5
6				Sample SB-16 4.0'-5.0' collected at 11:05.			6
7				<b>Refusal @ 5.0'</b>			7
8							8
9							9
10							10
11							11
12							12
13							13
14							14
15							15
16							16
17							17
18							18
19							19
20							20

CLIENT: Chiquita Holdings  
 PROJECT: Fuel-On Service Station  
 DRILLING COMPANY: Cribbs & Associates  
 LOGGED BY: J. Thorn

PROJECT # \_\_\_\_\_ DATE DRILLED: 1/22/2018  
 LOCATION: Curwensville, PA  
 RIG: Geo-Probe BOREHOLE: 2.5"  
 DRILLING METHOD: Macro-Sampler GW Level: N/A @ 0 hrs.

DEPTH (FT.)	SAMPLE ID	BLOWCOUNTS	RECOVERY (FEET)	DESCRIPTION	HEADSPACE	USCS	DEPTH (FT.)
—	S-1	N/A	2.5	(0.0'-0.3') Black <b>asphalt</b> and limestone gravel.	29.5		—
1				(0.3'-4.5') Brown and grey <b>Silt and gravel</b> , trace clay, some sand, damp.			1
2	S-2	N/A	2.5	Sample SB-15 2.0'-3.0' collected at 10:35.  (Fill)	99.4		2
3							S-3
4	S-4	N/A	1.5	(4.5'-6.0') Brown and grey <b>Silt and gravel</b> , little clay, damp to wet. Sample SB-15 4.0'-6.0' collected at 10:45. (Fill)	65.0		
5							S-4
6	S-4	N/A	1.5	(4.5'-6.0') Brown and grey <b>Silt and gravel</b> , little clay, damp to wet. Sample SB-15 4.0'-6.0' collected at 10:45. (Fill)	65.0	6	
7						S-4	N/A
8	S-4	N/A	1.5	(4.5'-6.0') Brown and grey <b>Silt and gravel</b> , little clay, damp to wet. Sample SB-15 4.0'-6.0' collected at 10:45. (Fill)	65.0		
9						S-4	N/A
10	S-4	N/A	1.5	(4.5'-6.0') Brown and grey <b>Silt and gravel</b> , little clay, damp to wet. Sample SB-15 4.0'-6.0' collected at 10:45. (Fill)	65.0		
11						S-4	N/A
12	S-4	N/A	1.5	(4.5'-6.0') Brown and grey <b>Silt and gravel</b> , little clay, damp to wet. Sample SB-15 4.0'-6.0' collected at 10:45. (Fill)	65.0		
13						S-4	N/A
14	S-4	N/A	1.5	(4.5'-6.0') Brown and grey <b>Silt and gravel</b> , little clay, damp to wet. Sample SB-15 4.0'-6.0' collected at 10:45. (Fill)	65.0		
15						S-4	N/A
16	S-4	N/A	1.5	(4.5'-6.0') Brown and grey <b>Silt and gravel</b> , little clay, damp to wet. Sample SB-15 4.0'-6.0' collected at 10:45. (Fill)	65.0		
17						S-4	N/A
18	S-4	N/A	1.5	(4.5'-6.0') Brown and grey <b>Silt and gravel</b> , little clay, damp to wet. Sample SB-15 4.0'-6.0' collected at 10:45. (Fill)	65.0		
19						S-4	N/A
20	S-4	N/A	1.5	(4.5'-6.0') Brown and grey <b>Silt and gravel</b> , little clay, damp to wet. Sample SB-15 4.0'-6.0' collected at 10:45. (Fill)	65.0		
20						S-4	N/A

CLIENT: Chiquita Holdings  
 PROJECT: Fuel-On Service Station  
 DRILLING COMPANY: Cribbs & Associates  
 LOGGED BY: J. Thorn

PROJECT # \_\_\_\_\_ DATE DRILLED: 1/22/2018  
 LOCATION: Curwensville, PA  
 RIG: Geo-Probe BOREHOLE: 2.5"  
 DRILLING METHOD: Macro-Sampler GW Level: N/A @ 0 hrs.

DEPTH (FT.)	SAMPLE ID	BLOWCOUNTS	RECOVERY (FEET)	DESCRIPTION	HEADSPACE	USCS	DEPTH (FT.)
–	S-1	N/A	3.7	(0.0'-0.5') Black <b>asphalt</b> and limestone gravel.	6.9		–
– 1 –				(0.5'-3.0') Brown and grey <b>Silt and gravel</b> , trace clay, little sand, Gravel is shale, sandstone and limestone, non-cohesive, damp.			– 1 –
– 2 –	S-2			(Fill)	9.9		– 2 –
– 3 –		(3.0'-4.0') Brown and grey <b>Silt</b> , little clay, trace gravel, moderate plasticity, damp. <i>Sample SB-14 3.0'-4.0' collected at 10:10.</i> (Fill)	26.1	– 3 –			
– 4 –	S-3	N/A	4.0	(4.0'-6.0') Brown and grey <b>Silt and gravel</b> , trace clay, moist to wet. <i>Sample SB-14 4.0'-6.0' collected at 10:20.</i> Wood Fragment at 5.5'. (Fill)	10.8		– 4 –
– 5 –				S-4	(6.0'-8.0') Grey <b>Silt</b> , trace clay, little fine sand, moist.		5.2
– 6 –	(Alluvial)				– 6 –		
– 7 –	S-5						– 7 –
– 8 –						– 8 –	
– 9 –				<b>Bottom of Boring @ 8.0'</b>			– 9 –
– 10 –							– 10 –
– 11 –							– 11 –
– 12 –							– 12 –
– 13 –							– 13 –
– 14 –							– 14 –
– 15 –							– 15 –
– 16 –							– 16 –
– 17 –							– 17 –
– 18 –							– 18 –
– 19 –							– 19 –
– 20 –							– 20 –



**pennsylvania**  
DEPARTMENT OF ENVIRONMENTAL  
PROTECTION

JULY 25, 2016

BM  
Daniel J. Scotti  
Chiquita Holdings LLC  
459 Meadow View Drive  
Vacaville, CA 95688

RECEIVED

JUL 29 2016

ICF International  
PAUSTIF

Re: Site Characterization Report/Remedial Action Plan Approval  
Storage Tank System Release: September 25, 2013  
Facility ID No.17-31221  
Facility Name: Uni Mart 04009  
Facility Address: 208 Filbert Street, Curwensville, PA  
Curwensville Borough, Clearfield County

Dear Mr. Scotti

The Department of Environmental Protection (Department) has reviewed the documents titled Site Characterization dated February 18, 2015 and Remedial Action Plan, dated May 23, 2016, for the release referenced above. The documents were prepared by Cribbs & Associates, Inc., and submitted as a Site Characterization Report (SCR) and Remedial Action Plan (RAP) as required by 25 Pa. Code § 245.310 and § 245.311, respectively. You selected the residential Statewide health standard as the remediation standard for soil and groundwater

The Department approves the SCR and RAP in accordance with Section 245.311(b)(2) with the following modification(s):

Soil excavation above the fully saturated zone should be undertaken in the areas (MW-3 and SB-1) that were identified during the site characterization. The proposed treatment system shall be installed based upon the submitted schedule.

Section 245.312(a) specifies that remedial action shall be implemented upon approval of the RAP according to the schedule contained in the RAP. Remedial action should, therefore, commence immediately upon receipt of this letter and proceed in accordance with the schedule in the RAP until the selected remediation standard is attained.

Remedial Action Progress Reports must be submitted to the Department in accordance with Section 245.312(b-d) by the 30<sup>th</sup> day of the month following the end of each quarter (April 30, July 30, October 30, and January 30). The final RAPR is submitted as part of the Remedial Action Completion Report. Your first RAPR should be submitted no later than October 30, 2016.

Failure to implement remedial action or submit complete progress reports in accordance with the schedule outlined above may result in enforcement action by the Department. If you wish to



modify any part of this RAP or select a new remediation standard, you must prepare and submit a new or modified RAP to the Department in accordance with Section 245.312(e).

Any person aggrieved by this action may appeal, pursuant to Section 4 of the Environmental Hearing Board Act, 35 P.S. Section 7514, and the Administrative Agency Law, 2 Pa.C.S. Chapter 5A, to the Environmental Hearing Board, Second Floor, Rachel Carson State Office Building, 400 Market Street, P.O. Box 8457, Harrisburg, PA 17105-8457, 717-787-3483. TDD users may contact the Board through the Pennsylvania Relay Service, 800-654-5984. Appeals must be filed with the Environmental Hearing Board within 30 days of receipt of written notice of this action unless the appropriate statute provides a different time period. Copies of the appeal form and the Board's rules of practice and procedure may be obtained from the Board. The appeal form and the Board's rules of practice and procedure are also available in braille or on audiotape from the Secretary to the Board at 717-787-3483. This paragraph does not, in and of itself, create any right of appeal beyond that permitted by applicable statutes and decisional law.

IF YOU WANT TO CHALLENGE THIS ACTION, YOUR APPEAL MUST REACH THE BOARD WITHIN 30 DAYS. YOU DO NOT NEED A LAWYER TO FILE AN APPEAL WITH THE BOARD.

IMPORTANT LEGAL RIGHTS ARE AT STAKE, HOWEVER, SO YOU SHOULD SHOW THIS DOCUMENT TO A LAWYER AT ONCE. IF YOU CANNOT AFFORD A LAWYER, YOU MAY QUALIFY FOR FREE PRO BONO REPRESENTATION. CALL THE SECRETARY TO THE BOARD (717-787-3483) FOR MORE INFORMATION.

If you have questions, please contact me at 570.327.3778 or by email to [oferguson@pa.gov](mailto:oferguson@pa.gov).

Sincerely,

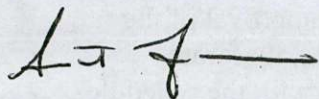

Scott Ferguson, P.G.  
Licensed Professional Geologist  
Storage Tank Section  
Environmental Cleanup and Brownfields

cc: ICF Consulting  
Steve Webster  
Gary Cribbs, P.G.  
File