

FIGURE 2 SITE PLAN - SOIL BORING AND MONITORING WELL LOCATION MAP		
REMEDIAL ACTION PROGRESS REPORT HARPER OIL COMPANY/HEATH OIL INC-SENECA MINI MART SENECA, PENNSYLVANIA PADEP FACILITY ID# 65-18854		
SENECA BOROUGH VENANGO COUNTY, PENNSYLVANIA		
DATE: 10/4/18	APPROX. SCALE: See Scale Bar	DRAWN BY: RRB

- LEGEND**
- MW-1 MONITORING WELL LOCATION
 - SB-1 SOIL BORING LOCATION
 - VP-1 VAPOR POINT LOCATION
 - FORMER UST LOCATION
TANKS REMOVED
SEPTEMBER 14-17, 2015
 - CURRENT AST LOCATION
 - FORMER PRODUCT
LINE LOCATION
 - FORMER UST LOCATION
TANK REMOVED
FEBRUARY 11, 1999
 - G GASOLINE DISPENSER
 - D DIESEL DISPENSER
 - K KEROSENE DISPENSER
 - UTILITIES (DEPTHS MARKED IF KNOWN)
 - GAS LINE
 - WATER LINE
 - SANITARY SEWER
 - STORM SEWER
- THREE ADDITIONAL SOIL BORINGS, SB-21, SB-25 AND SB-26, (NOT SHOWN) WERE ADVANCED IMMEDIATELY ADJACENT TO PREVIOUSLY SAMPLED LOCATIONS, SB-15, SB-3 AND SB-11, RESPECTIVELY, TO COLLECT SOIL SAMPLES FROM AREAS OF KNOWN IMPACT IN ORDER TO OBTAIN DISPOSAL ANALYTICAL RESULTS FOR COMPLETING FORM FC-1 IN ANTICIPATION OF SOIL EXCAVATION ACTIVITY.

CRBBS
Associates, Inc.

P.O. BOX 44
DELMONT, PA 15626

SURVEY FIELD WORK PREPARED BY MORRIS
KNOWLES AND ASSOCIATES INC.

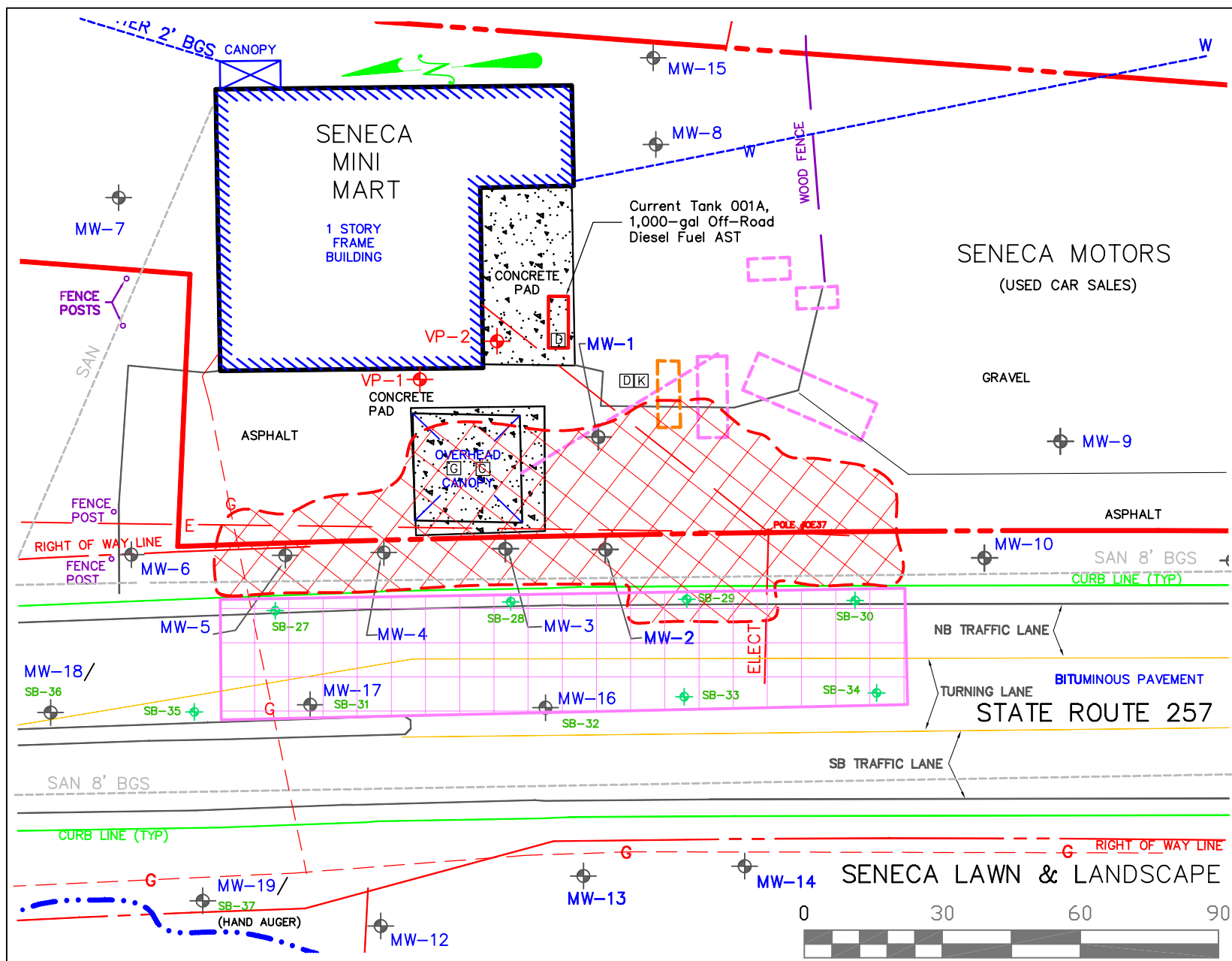

FIGURE 3 REMEDIAL SOIL EXCAVATION (DETAIL) OCTOBER 2018 Rev.		
REMEDIAL ACTION PROGRESS REPORT HARPER OIL COMPANY/HEATH OIL INC-SENECA MINI MART SENECA, PENNSYLVANIA PADEP FACILITY ID# 65-18854		
SENECA BOROUGH VENANGO COUNTY, PENNSYLVANIA		
DATE: 10/10/18	APPROX. SCALE: See Scale Bar	DRAWN BY: RRB

LEGEND

- MW-1 MONITORING WELL LOCATION
- SB-27 SOIL BORING LOCATION
- VP-1 VAPOR POINT LOCATION
- FORMER UST LOCATION
TANKS REMOVED
SEPTEMBER 14-17, 2015
- CURRENT AST LOCATION
- FORMER PRODUCT LINE LOCATION
- FORMER UST LOCATION
TANK REMOVED
FEBRUARY 11, 1999
- AREA OF IMPACTED SOIL TO
BE EXCAVATED ESTIMATED
VOLUME 1200-1250 YDS
- AREA OF POTENTIAL RANDOM
SYSTEMATIC SOIL SAMPLING
(POST-DIG)
- G FORMER GASOLINE DISPENSER
- D FORMER DIESEL DISPENSER
- K FORMER KEROSENE DISPENSER
- UTILITIES (DEPTHS MARKED IF KNOWN)**
 - GAS LINE
 - WATER LINE
 - SANITARY SEWER
 - STORM SEWER

CRIBBS & Associates, Inc.

**Updated Post-RAP
Excavation Footprint**